

DRAWING

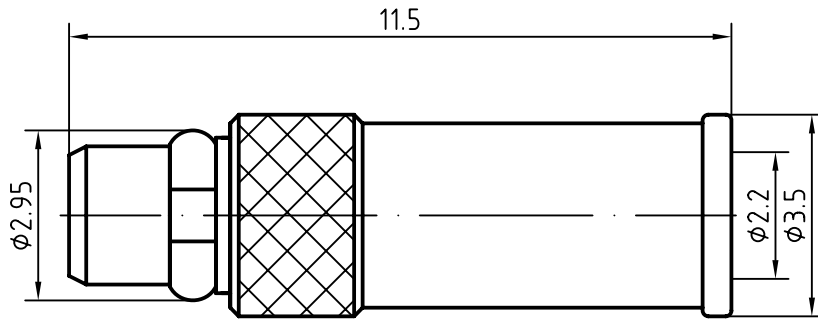

CABLE(UT086,RG405,670-086)

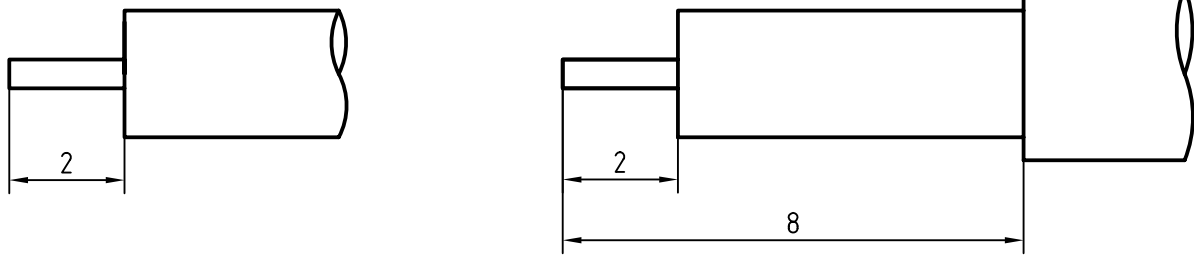

With jacket

4	1	Body	Brass/Gold plated	Gold 0.2um over Nickel 2um
3	1	Spring ring	Beryllium bronze/Gold plated	Gold 0.2um over Nickel 2um
2	1	Insulator	PFTE	
1	1	Center contact	Brass/Gold plated	Gold 0.5um over Nickel 2um

Designed by Mingang Han	Checked by Jinlong Gu	Approved by - date Hongyu Du	File name MMCX-JB2	Date 07.07.10	Scale 1 : 1
----------------------------	--------------------------	---------------------------------	-----------------------	------------------	----------------

Amitron Electronics, Ltd.	MMCX-JB2			
	<a href="http://www.amel.ru">http://www.amel.ru</a>	Edition 1.0	Sheet 1/1	

## CHARACTERISTICS

DESCRIPTION: MMCX Type male connector

### Electrical data:

<i>Impedance:</i>	50 ohm
<i>Frequency range:</i>	DC to 6 GHz
<i>Return loss:</i>	≥30dB, DC-1GHz ≥25dB, 1-2.5GHz ≥19dB, 2.5-6GHz
<i>Insertion loss:</i>	≤0.15X √f[GHz]dB, DC-6GHz
<i>Insulation resistance:</i>	≥1000MΩ
<i>Test voltage:</i>	500 V rms
<i>Working voltage:</i>	150 V rms
<i>Contact resistance:</i>	
1). Centre contact:	5.0 mΩ
2). Outer conductor:	2.5 mΩ
<i>RF leakage(measured at 1GHz):</i>	≥70dB

### Environmental data:

<i>Temperature rating:</i>	-55 ° C to +155 ° C
<i>2002/95/EC (RoHS):</i>	Compliant

### Mechanical data:

<i>Mating cycles:</i>	≥500
<i>Center contact captivation:</i>	≥10 N(axial)
<i>Engagement force:</i>	≤15 N
<i>Disengagement force:</i>	6N~15N

### Suitable cables:

0.86/670-086/670-086 SXE/680-086

Amitron Electronics, Ltd.

<http://www.amel.ru>

e-mail: [mailbox@amel.ru](mailto:mailbox@amel.ru)